

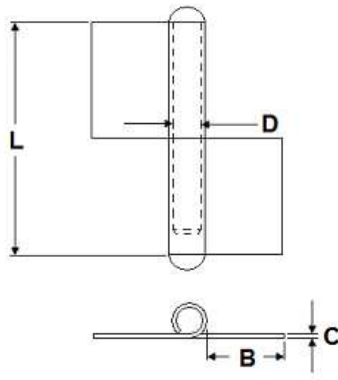

Hinges
Hardware
& Mixers



LEFT HAND HINGE



RIGHT HAND HINGE

Code no. 17-020 ROLLED FLAG HINGES

- Loose pin, 2 part rolled hinges
- With round end caps, no holes
- Hinges are handed

Options

- Hinge Material Steel, Stainless Steel
- Pin Material Steel, Stainless Steel, Brass
- End cap is optional
- Finish

The steel hinges are self colour; the stainless steel hinges have polished or matt finish.

Code	Length = L	Width = B	Thickness = C	Pin dia = D	Hinge Material	Pin Material	Washer Material	Weight (g)
17-020A	80	30	3	10	Steel	Steel	Brass	180
17-020ASP	80	30	3	10	Steel	Stainless Steel	Brass	180
17-020AST	80	30	3	10	Stainless Steel	Stainless Steel	Stainless Steel	180
17-020AB	80	30	3	10	Steel	Brass	Brass	180
17-020B	100	30	3	10	Steel	Steel	Brass	220
17-020BSP	100	30	3	10	Steel	Stainless Steel	Brass	220
17-020BST	100	30	3	10	Stainless Steel	Stainless Steel	Stainless Steel	220
17-020BB	100	30	3	10	Steel	Brass	Brass	220
17-020C	140	50	4	14	Steel	Steel	Brass	720
17-020CB	140	50	4	14	Steel	Brass	Brass	720
17-020CST	140	50	3	13	Stainless Steel	Stainless Steel	*no washer	720
17-020D	160	50	4	14	Steel	Steel	Brass	840
17-020DB	160	50	4	14	Steel	Brass	Brass	840
17-020DST	160	50	4	16	Stainless Steel	Stainless Steel	*no washer	840
17-020E	180	50	5	16	Steel	Steel	Brass	900
17-020EB	180	50	5	16	Steel	Brass	Brass	900
17-020EST	180	50	5	16	Stainless Steel	Stainless Steel	*no washer	900
17-020F	200	50	5	16	Steel	Steel	Brass	1000
17-020FB	200	50	5	16	Steel	Brass	Brass	1000
17-020FST	200	50	5	16	Stainless Steel	Stainless Steel	*no washer	1000
17-020GST	200	50	6	20	Stainless Steel	Stainless Steel	*no washer	1150

Dimensions in mm