

CALMORE

Hinges
Hardware
& Mixers

Code no. 34-040

HEAVY DUTY ROLLED BUTT HINGES

Heavy duty, in mild steel material

Round head pin

Self colour

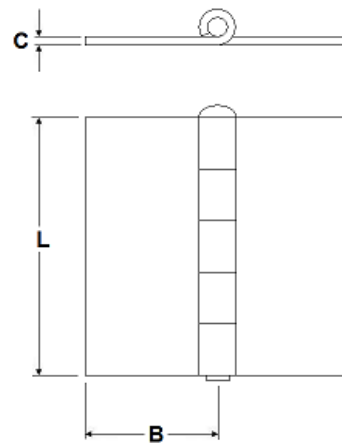
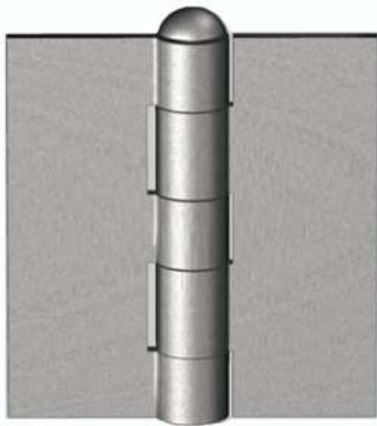

Code	Length = L	Width = B	Thickness = C	Pin dia = d	Knuckles
34-040A	60	27.5	3	6	5
34-040B	75	30	3	6.5	5
34-040C	90	32.5	3	7	5
34-040D	95	32.5	3	7	5
34-040E	100	37.5	3	8	5
34-040G	80	40	3	7	5

Dimensions in mm

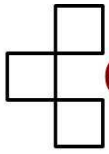

CALMORE

Hinges
Hardware
& Mixers

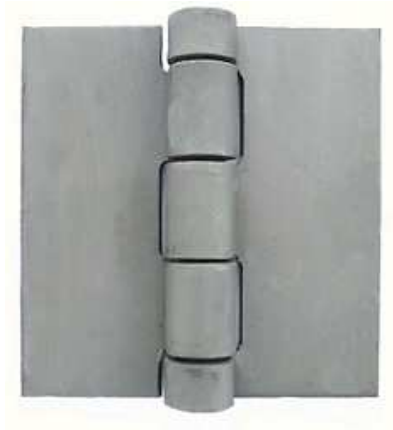

34-040J

Code no. 34-040

HEAVY DUTY ROLLED BUTT HINGES

Heavy duty, in mild steel material

Flush riveted pin

Self colour

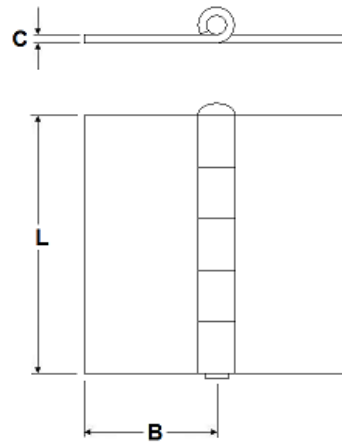

WITH FIXED FLUSH PIN OR RIVETED PIN

Code	Length = L	Width = B	Thickness = C	Pin dia = d	Knuckles
34-040J	102	51	4.5	10	5
34-040K	102	51	4.5	12	3
34-040L	152	76	4.7	10	7
34-040M	127	63.5	4.7	12.7	3

WITH PHOSPHOR BRONZE RIVETED PIN

Code	Length = L	Width = B	Thickness = C	Pin dia = d	Knuckles
34-040P	63.5	150	3	5.5	3
34-040Q	76	152	3	5.5	5
34-040R	102	254	3	6.3	5

Dimensions in mm



Hinges
Hardware
& Mixers

Code no. 34-041
HEAVY DUTY ROLLED BUTT HINGES
Unequal butt hinge
Heavy duty, in mild steel material
Flush riveted pin

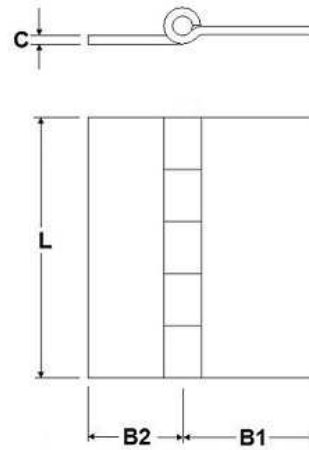
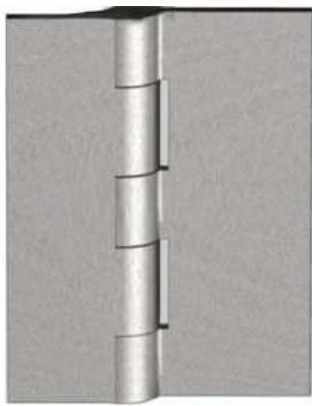

Code	Length = L	Width = B1	Width = B2	Thickness = C	Pin dia = d	Knuckles
34-041A	60	31.5	23.5	3.5	7	5
34-041B	75	31.5	23.5	3.5	7	5
34-041C	90	31.5	23.5	3.5	7	5

Dimensions in mm