

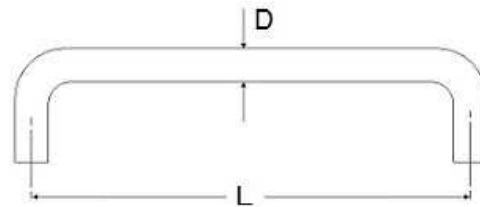

Code no. 99-06
STAINLESS STEEL 'D' HANDLES

■ TUBULAR SECTION PULL HANDLES with bolt through fixings

Options

- Material stainless steel (ST/ST) 304 grade
- Finishes polished =P, satin=S
- Roses to suit tubular section pull handles
- Back to back fixing kit



Code	Handle Diameter = D	Length = L	Material	Finish S=satin P=polished
99-06001	19	150	STST 304	S, P
99-06002	19	225	STST 304	S, P
99-06003	19	300	STST 304	S, P
99-06004	19	425	STST 304	S, P
99-06005	19	600	STST 304	S, P
99-06006	22	225	STST 304	S, P
99-06007	22	300	STST 304	S, P
99-06008	25	225	STST 304	S, P
99-06009	25	300	STST 304	S, P
99-06010	25	425	STST 304	S, P
99-06011	25	600	STST 304	S, P

BACK TO BACK FIXING KIT TO SUIT TUBULAR SECTION PULL HANDLES

Suitable for timer or glass application

Code	Material
99-06000	STST

ROSES TO SUIT TUBULAR SECTION PULL HANDLES

Code	Handle Diameter = D	Rose diameter	Rose Thickness	Material	Finish S=satin P=polished
99-0603R	19	50	5	STST 304	S, P
99-0605R	22	50	5	STST 304	S, P
99-0606R	25	50	5	STST 304	S, P

Code no. 99-06 CABINET 'D' HANDLES

■ TUBULAR SECTION PULL HANDLES



Options

- Material -
- Finishes polished =P, satin=S

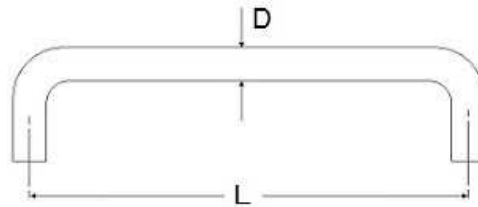

Code	Handle Diameter = D	Length = L	Material	Finish S=satin P=polished
99-06B31	10	102	Brass	P
99-06B57	10	102	Anodised Aluminium	S
99-06B60	10	102	STST 304	S
99-06B72	10	152	Anodised Aluminium	S
99-06B32	19	152	Brass	P
99-06B33	19	225	Brass	P
99-06B34	19	302	Brass	P

Dimensions are approximate and may vary

Dimensions in mm

Code no. 99-06
STAINLESS STEEL HANDLES

■ TUBULAR SECTION PULL HANDLES with bolt through fixings

Options

- Material stainless steel (ST/ST) 304 grade
- Finishes polished =P, satin=S
- Roses to suit tubular section pull handles
- Back to back fixing kit

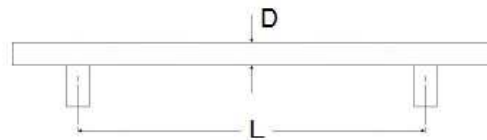

Code	Handle Diameter = D	Length = L	Material	Finish S=satin P=polished
99-06065	19	325 / 225	STST 304	S, P
99-06066	19	400 / 300	STST 304	S, P
99-06067	19	1000 / 900	STST 304	S, P
99-06068	25	400 / 300	STST 304	S, P
99-06069	25	600 / 450	STST 304	S, P
99-06070	25	750 / 650	STST 304	S, P
99-06071	25	1000 / 900	STST 304	S, P

ROSES TO SUIT TUBULAR SECTION PULL HANDLES

Code	Handle Diameter = D	Rose diameter	Rose Thickness	Material	Finish S=satin P=polished
99-0603R	19	50	5	STST 304	S, P
99-0606R	25	50	5	STST 304	S, P

BACK TO BACK FIXING KIT TO SUIT TUBULAR SECTION PULL HANDLES
 Suitable for timber or glass application

Code	Material
99-06000	STST

Dimensions are approximate and may vary

Dimensions in mm

Code no. 99-06
STAINLESS STEEL 'D' HANDLES

■ SOLID SECTION PULL HANDLES with bolt through fixings

Options

- Material stainless steel (ST/ST) 304 grade, 316 grade
- Finishes polished=P, satin=S
- Roses to suit solid section pull handles

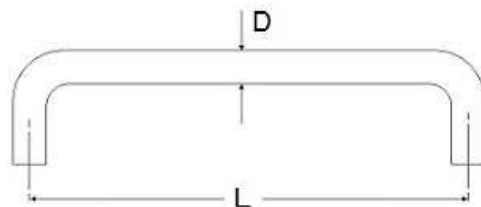

Code	Handle Diameter = D	Length = L	Material	Finish S=satin P=polished
99-06012	16	150	STST 304	S
99-06013	16	225	STST 304	S
99-06014	16	300	STST 304	S
99-06015	19	150	STST 304	S, P
99-06016	19	150	STST 316	S, P
99-06017	19	225	STST 304	S, P
99-06018	19	225	STST 316	S, P
99-06019	19	300	STST 304	S, P
99-06020	19	300	STST 316	S, P
99-06021	19	400	STST 304	S, P
99-06022	19	425	STST 304	S
99-06023	19	600	STST 304	S, P
99-06024	22	225	STST 304	S, P
99-06025	22	300	STST 304	S, P
99-06026	25	425	STST 304	S, P
99-06027	25	600	STST 304	S, P

ROSES TO SUIT SOLID SECTION PULL HANDLES

Code	Handle Diameter = D	Rose diameter	Rose Thickness	Material	Finish S=satin P= polished
99-0652R	16	50	5	STST 304	S
99-0653R	19	50	5	STST 304	S, P
99-0654R	19	50	5	STST 316	S, P
99-0655R	22	50	5	STST 304	S, P
99-0656R	25	50	5	STST 304	S, P

Dimensions are approximate and may vary

Dimensions in mm



Code no. 99-06 ALUMINIUM 'D' HANDLES

■ PULL HANDLES

Options

- Material -
- Finishes - polished=P, satin=S

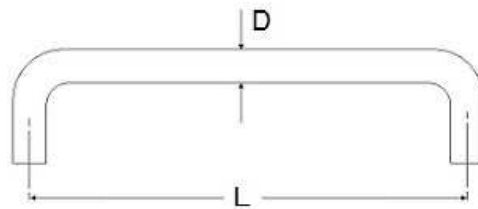

BOLT THROUGH PULL HANDLES

Code	Handle Diameter = D	Length = L	Material	Finish S=satin P=polished
99-06028	10	100	Aluminium	S
99-06029	10	150	Aluminium	S
99-06030	19	150	Aluminium	S, P
99-06031	19	225	Aluminium	S, P
99-06032	19	300	Aluminium	S, P
99-06033	19	425	Aluminium	S
99-06034	19	600	Aluminium	S
99-06035	22	225	Aluminium	P
99-06036	22	300	Aluminium	P



CONCEALED FIX PULL HANDLES ON ROSES

Code	Handle Diameter = D	Length = L	Material	Finish S=satin P=polished
99-06055	19	150	Aluminium	S, P
99-06056	19	225	Aluminium	S, P
99-06057	19	300	Aluminium	S, P
99-06058	22	225	Aluminium	P
99-06059	22	300	Aluminium	P

Dimensions are approximate and may vary

Dimensions in mm

Code no. 99-06
BACK TO BACK 'D' HANDLES

- SOLID SECTION PULL HANDLES with back to back fixings

Options

- Material stainless steel (ST/ST) 304 grade, Aluminium
- Finishes polished=P, satin=S
- Roses to suit solid section pull handles

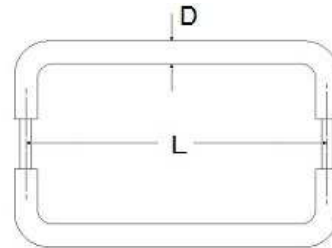

Code	Handle Diameter = D	Length = L	Material	Finish S=satin P=polished
99-06520	19	150	STST 304	S, P
99-06521	19	225	STST 304	S, P
99-06522	19	300	STST 304	S, P
99-06523	19	650	STST 304	S
99-06524	22	225	STST 304	S, P
99-06525	22	300	STST 304	S, P
99-065A1	19	150	Aluminium	P
99-065A2	19	225	Aluminium	S, P
99-065A3	19	300	Aluminium	S, P
99-065A4	22	225	Aluminium	P
99-065A5	22	300	Aluminium	P

ROSES TO SUIT SOLID SECTION PULL HANDLES

Code	Handle Diameter = D	Rose diameter	Rose Thickness	Material	Finish S=satin P=polished
99-0653R	19	50	5	STST 304	S, P
99-0654R	19	50	5	STST 316	S, P
99-0655R	22	50	5	STST 304	S, P

Dimensions are approximate and may vary

Dimensions in mm

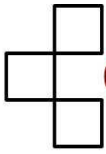

CALMORE

Hinges
Hardware
& Mixers

Code no. 99-06
STAINLESS STEEL PULL HANDLES



■ SOLID SECTION PULL HANDLES with back to back fixings

Options

- Material stainless steel (ST/ST) 304 grade
- Finishes polished=P, satin=S
- Roses to suit solid section pull handles

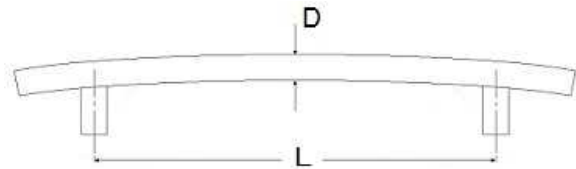

Code	Handle Diameter = D	Length = L	Material	Finish S=satin P=polished
99-06T44	19	300	STST 304	S, P

Dimensions are approximate and may vary

Dimensions in mm

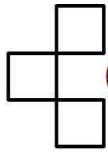

CALMORE

Hinges
Hardware
& Mixers

Code no. 99-06 OTHER PULL HANDLES

■ PULL HANDLES

Options

- Material -
- Finishes - polished brass=B, satin anodised Aluminium=A
polished chrome=P, satin chrome=S

Code	Handle Diameter = D	Length = L	Material	Finish S=satin chrome P=polished chrome B=polished brass A=anodized Alu.
------	------------------------	---------------	----------	--

SASH HANDLES



99-06S01		102		B, P, S
99-06S45		125		B, P, S
99-06S46		152		B, P, S

CLASSICAL HANDLES



99-06S20		252		B
99-06S21		302		B

OVAL GRIP PULL HANDLES



99-06S33		225		B, P, S, A
99-06S34		300		B, S, A

Dimensions are approximate and may vary

Dimensions in mm

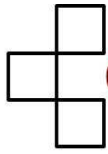

CALMORE

Hinges
Hardware
& Mixers

Code no. 99-06 OTHER SHAPED PULL HANDLES

■ BACK TO BACK

Code	Handle Diameter = D	Length = L	Material	Finish S=satin STST P=polished STST
------	------------------------	---------------	----------	---

PULL
HANDLES



99-06S56	25	300	STST 304	S, P
----------	----	-----	----------	------

PULL
HANDLES



99-06S55	32	610	STST 304	S, P
----------	----	-----	----------	------

PULL
HANDLES



99-06S57	25	350	STST 304	S, P
----------	----	-----	----------	------

PULL
HANDLES



99-06S58	25	300	STST 304	S, P
----------	----	-----	----------	------

Dimensions are approximate and may vary

Dimensions in mm